

CANADIAN MUSIC WEEK 2017

LOWER CONCOURSE LEVEL

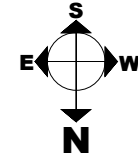

REVISION DATE:
12/16/2016 YS

BOOTH COUNT

Exhibit Hall as of 12/16/2016

| Dimension | Size | Qty | SqFt |
|----------------|------|-----------|--------------|
| 8'x10' | 80 | 27 | 2,160 |
| 8'x8' | 64 | 1 | 64 |
| Totals: | | 28 | 2,224 |

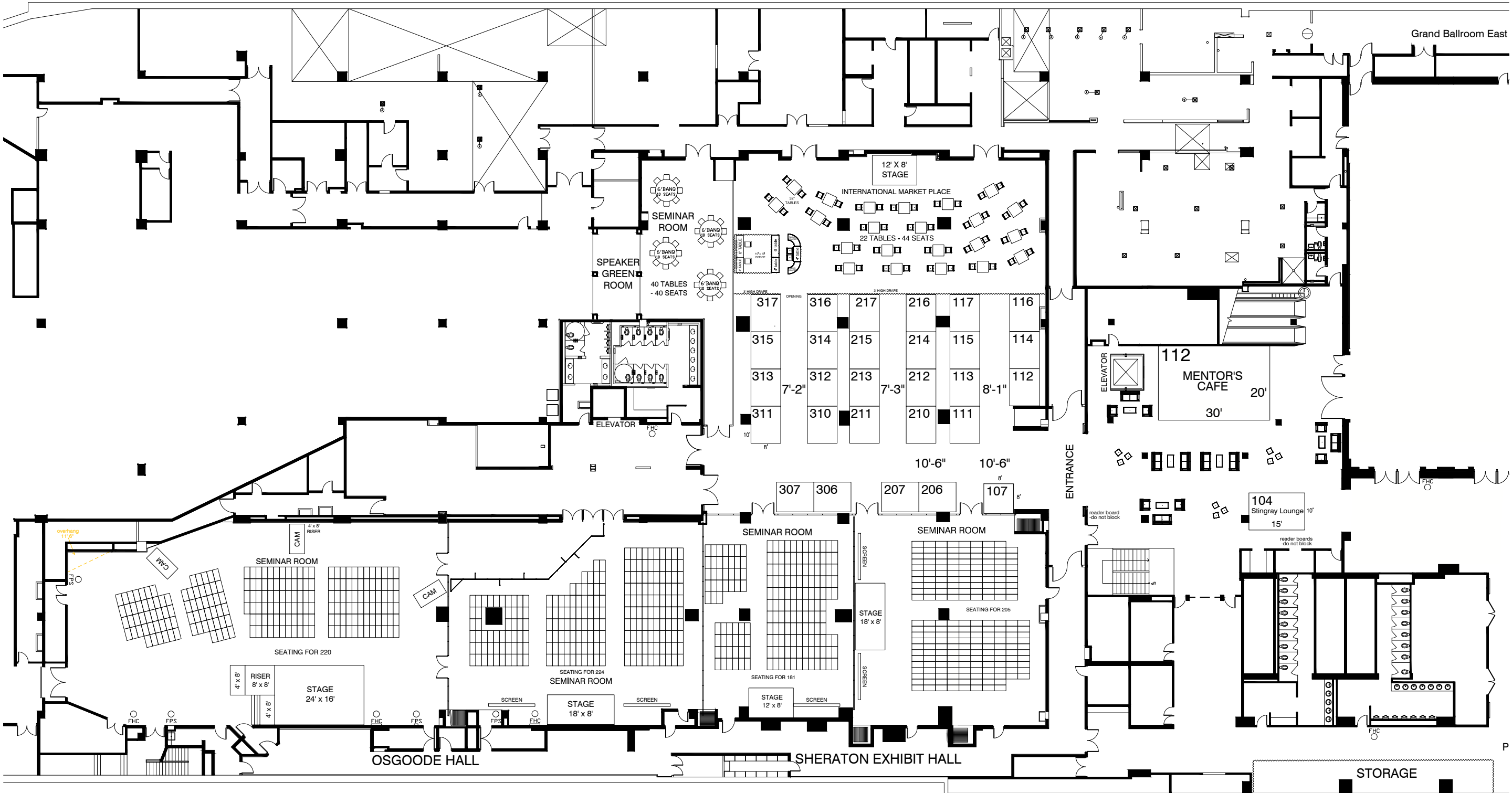

BLDG. LEGEND:

FREEMAN

DRAWING STARTED:
12/16/2016 YS
FILE PATH:
CDN Music Week 2017 FP.dwg

DRAWING NAME:
CDN MUSIC WEEK 2017 FP
HALL NAME:
SHERATON CENTRE
JOB NUMBER:
-
ACCT. EXEC.:
LCM

NOT TO SCALE

DISCLAIMER

EVERY EFFORT HAS BEEN MADE TO ENSURE THE ACCURACY OF ALL INFORMATION CONTAINED ON THIS FLOORPLAN. HOWEVER NO WARRANTIES, EITHER EXPRESSED OR IMPLIED ARE MADE WITH RESPECT TO THIS FLOORPLAN. IF THE LOCATION OF BUILDING COLUMNS, UTILITIES OR OTHER ARCHITECTURAL COMPONENTS OF THE FACILITY IS A CONSIDERATION IN THE CONSTRUCTION OR USAGE OF AN EXHIBIT, IT IS THE SOLE RESPONSIBILITY OF THE EXHIBITOR TO PHYSICALLY INSPECT THE FACILITY TO VERIFY ALL DIMENSIONS AND LOCATIONS.
© COPYRIGHT 2007, FREEMAN CO.
ALL RIGHTS RESERVED.

CONFIDENTIAL & PROPRIETARY

The information contained herein and attached to this email is the proprietary information of Freeman and by accessing the information, the recipient agrees to keep the information confidential and not disclose it to any third party without the prior consent of Freeman. Recipient also agrees to only use the information for its internal evaluation purposes and for no other purpose, without the prior consent of Freeman.

THE SHERATON CENTRE
SHERATON EXHIBIT HALL & OSGOODE BALLROOM

CANADIAN MUSIC WEEK 2017

CONCOURSE LEVEL

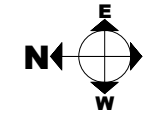

REVISION DATE:
12/16/2016 YS

BOOTH COUNT

SIGNS

| | | |
|-----|-------|---------|
| W-1 | 5'9" | 45-1/2" |
| W-2 | 5'9" | 45-1/2" |
| W-3 | 6'11" | 45-1/2" |
| W-4 | 6'11" | 45-1/2" |

NB. 45-1/2" IS THE MAXIMUM HEIGHT FROM TOP OF WINDOW TO CEILING

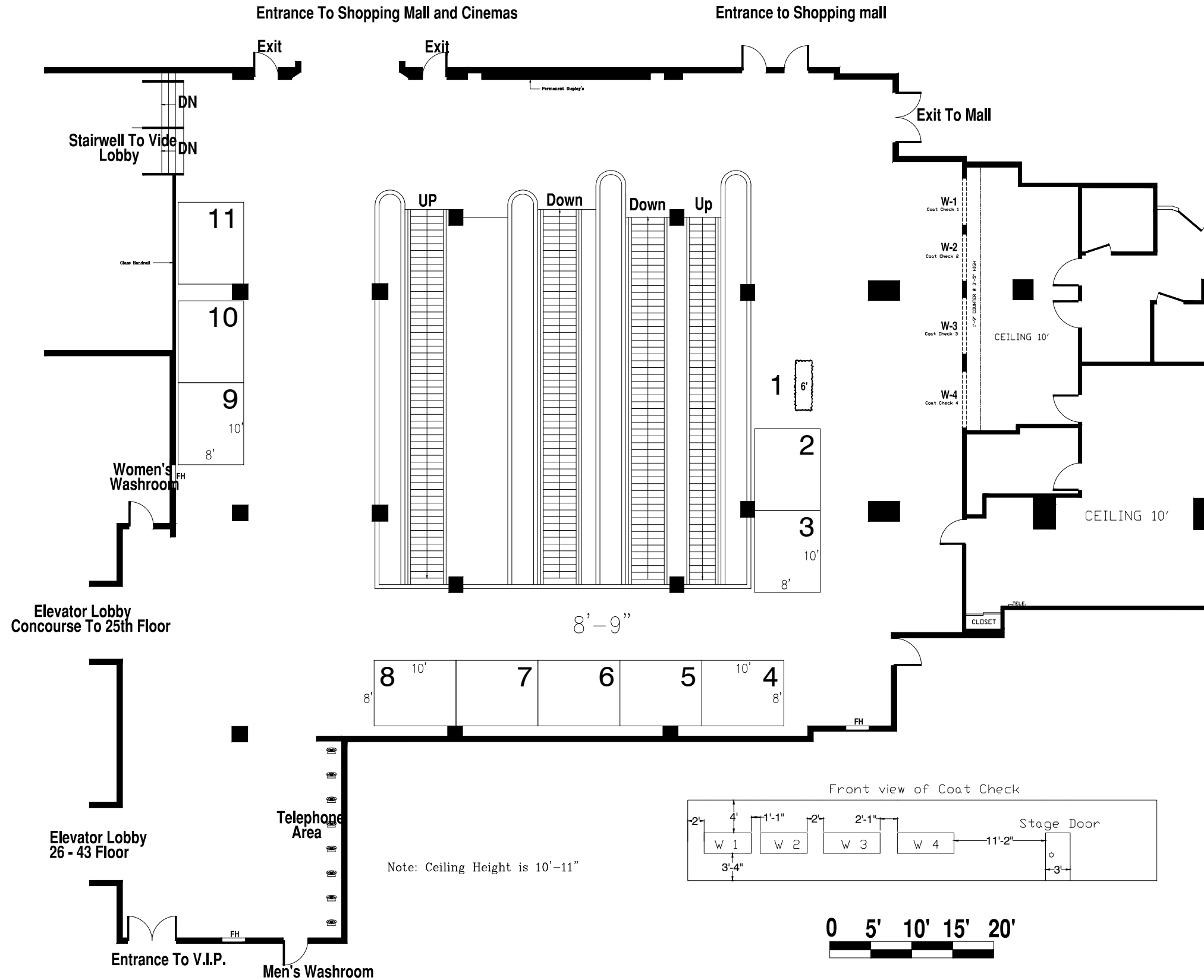

BLDG. LEGEND:

FREEMAN

DRAWING STARTED:
12/16/2016 YS
FILE PATH:
CDN Music Week 2017 FP.dwg

DRAWING NAME:
CDN MUSIC WEEK 2017 FP
HALL NAME:
SHERATON CENTRE
JOB NUMBER:
-
ACCT. EXEC.:
LCM

NOT TO SCALE

DISCLAIMER

EVERY EFFORT HAS BEEN MADE TO ENSURE THE ACCURACY OF ALL INFORMATION CONTAINED ON THIS FLOORPLAN. HOWEVER NO WARRANTIES, EITHER EXPRESSED OR IMPLIED ARE MADE WITH RESPECT TO THIS FLOORPLAN. IF THE LOCATION OF BUILDING COLUMNS, UTILITIES OR OTHER ARCHITECTURAL COMPONENTS OF THE FACILITY IS A CONSIDERATION IN THE CONSTRUCTION OR USAGE OF AN EXHIBIT, IT IS THE SOLE RESPONSIBILITY OF THE EXHIBITOR TO PHYSICALLY INSPECT THE FACILITY TO VERIFY ALL DIMENSIONS AND LOCATIONS.
© COPYRIGHT 2007, FREEMAN CO. ALL RIGHTS RESERVED.

CONFIDENTIAL & PROPRIETARY
The information contained herein and attached to this email is the proprietary information of Freeman and by accessing the information, the recipient agrees to keep the information confidential and not disclose it to any third party without the prior consent of Freeman. Recipient also agrees to only use the information for its internal evaluation purposes and for no other purpose, without the prior consent of Freeman.